

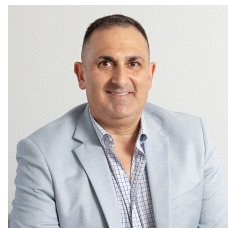

**398 Keira Street Wollongong NSW**

- \* Approx 1053 sqm of air conditioned showroom
- \* 1958sqm of IN1 - General Industrial
- \* High Exposure Corner lot
- \* Approx 220sqm of mezzanine area
- \* 13 car spaces
- \* Drop ceiling throughout entire showroom

**Type** : Retail  
**Building Size** : 1053 sqm  
**Land Size** : 1958 sqm  
**View** : <https://www.whkcommercial.com.au/sale/nsw/wollongong-illawarra/wollongong/commercial/retail/8045820>



**Harry Stefanou**  
02 4229 6640



**Tony Moschella**  
02 4229 6640

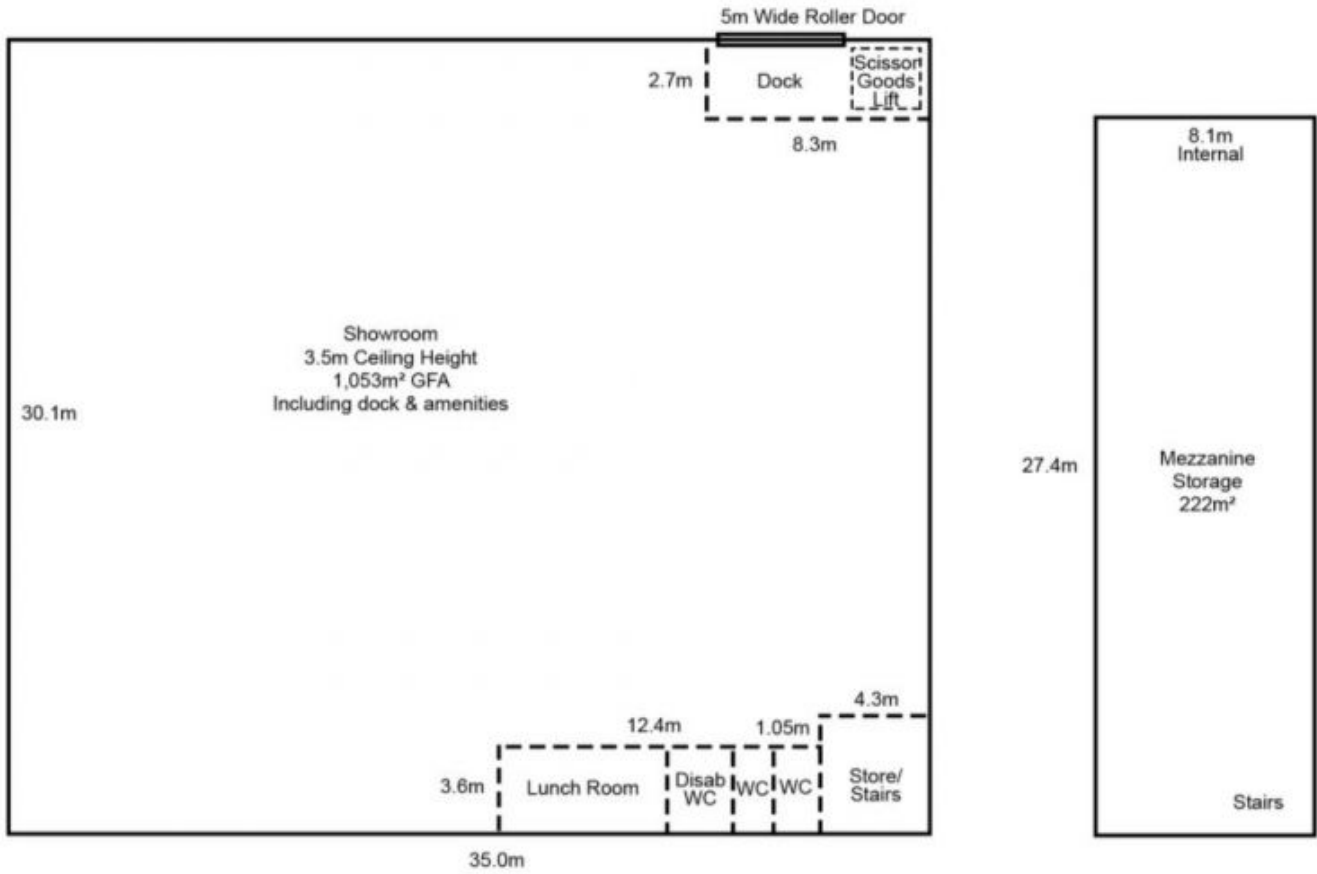

11 Car Parking Spaces Including 1 Disabled Space

\* All sizes and dimensions are approximate only