



102 Shellharbour Road Warilla NSW

6 

- * Recently used as Dental Surgery with reception and disable access
- * Six off street parking spaces Plus large 7.5m x 9m three car garage
- * 727m2 freehold property directly opposite Warilla Grove Shopping Centre
- * Ideal for Medical Suites, Consult rooms, Law or Accounting firms. (STCA)
- * High exposure to six lane major road
- * 4 x Consultation rooms + Reception + Large waiting room
- * 2 x staff kitchen areas + staff toilet and showers
- * Ducted Air Conditioning throughout
- * Disabled amenities

Type : Healthcare
Price : \$ 785,000
Building Size : 98 sqm
Land Size : 727 sqm
View : <https://www.whkcommercial.com.au/sale/nsw/wollongong-illawarra/warilla/commercial/healthcare/8045942>



Tony Moschella

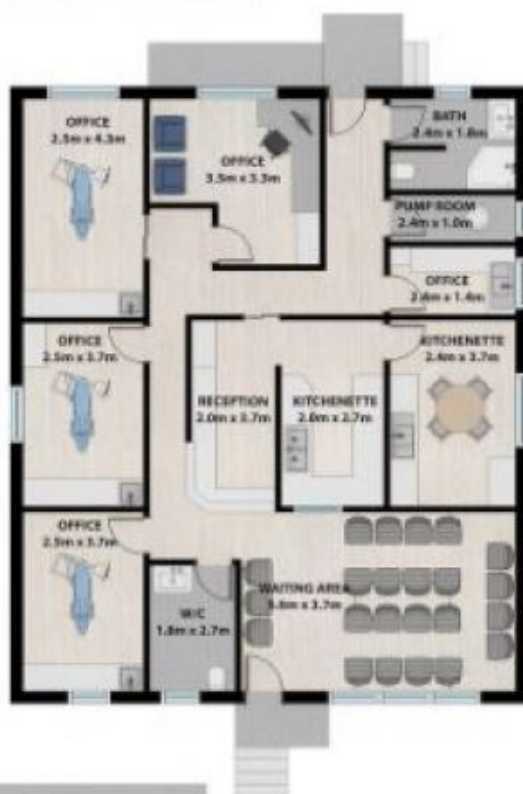
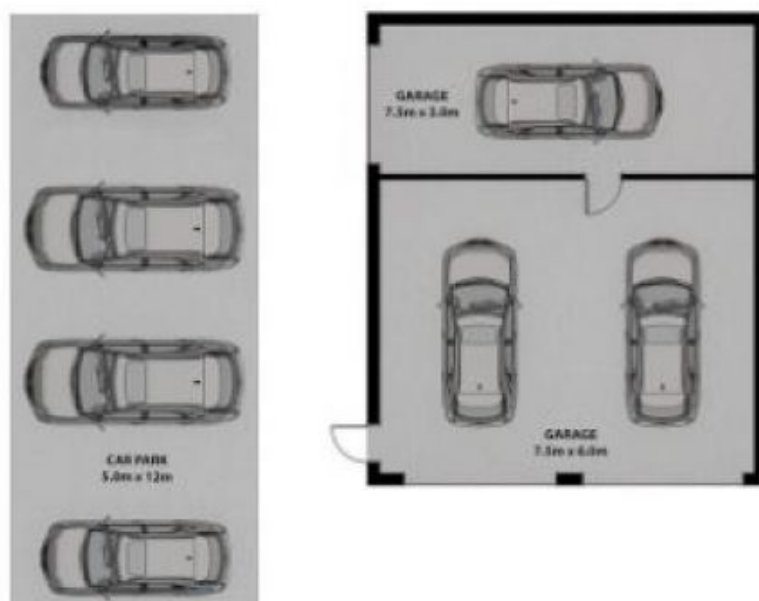

INTERNAL : 98.1m²
GARAGE : 67.5m²
CAR PARK: 87m²

TOTAL: 252.6m²