



**1a/161 Remembrance Drive Tahmoor NSW**

**45** 

\* Amazing opportunity to Lease over 2000sqm of retail space

\* Previously fit out as independent supermarket chain

\* Rear loading dock with ample storage facilities for cold / frozen and fresh produce

\* Great office space as well as staff facilities and amenities

\* Excellent customer parking

OR OTHER OPTIONS ALSO AVAILABLE:

[For full version visit the website](https://www.whkcommercial.com.au)

**Type** : Retail  
**Price** : Contact Agent pa  
**Building Size** : 2020 sqm  
**View** : <https://www.whkcommercial.com.au/lease/nsw/southern-highlands/tahmoor/commercial/retail/8046900>

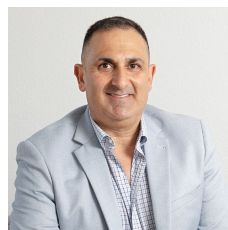

**Harry Stefanou**  
02 4229 6640



**Tony Moschella**  
02 4229 6640

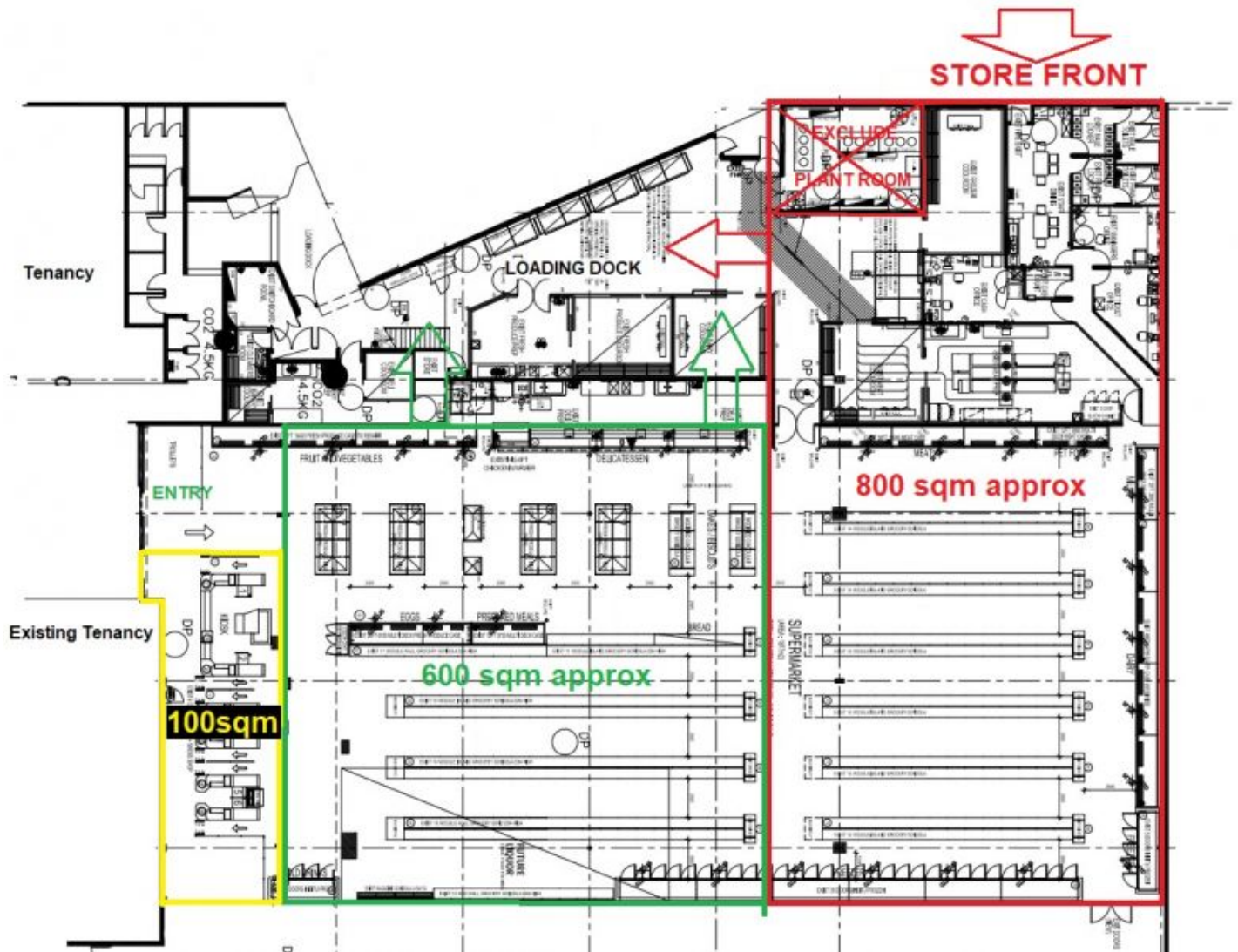

**COPYRIGHT**  
 ALL RIGHTS RESERVED BY THE ARCHITECT. NO PART OF THIS DOCUMENT MAY BE REPRODUCED OR TRANSMITTED IN ANY FORM OR BY ANY MEANS, ELECTRONIC OR MECHANICAL, WITHOUT THE WRITTEN PERMISSION OF THE ARCHITECT.

**DIMENSIONS**  
 UNLESS OTHERWISE SPECIFIED, ALL DIMENSIONS ARE IN METERS TO THE CENTERLINE OF WALLS AND TO THE FACE OF PARTITIONS UNLESS NOTED OTHERWISE.

**DATE** 08/20/2014

**SCALE** 1:100

**PROJECT** SUPERMARKET

**CLIENT** NEW TENANCY

**ARCHITECT** FOODWORKS

**DATE** 08/20/2014

**SCALE** 1:100

**PROJECT** SUPERMARKET

**CLIENT** NEW TENANCY

**ARCHITECT** FOODWORKS

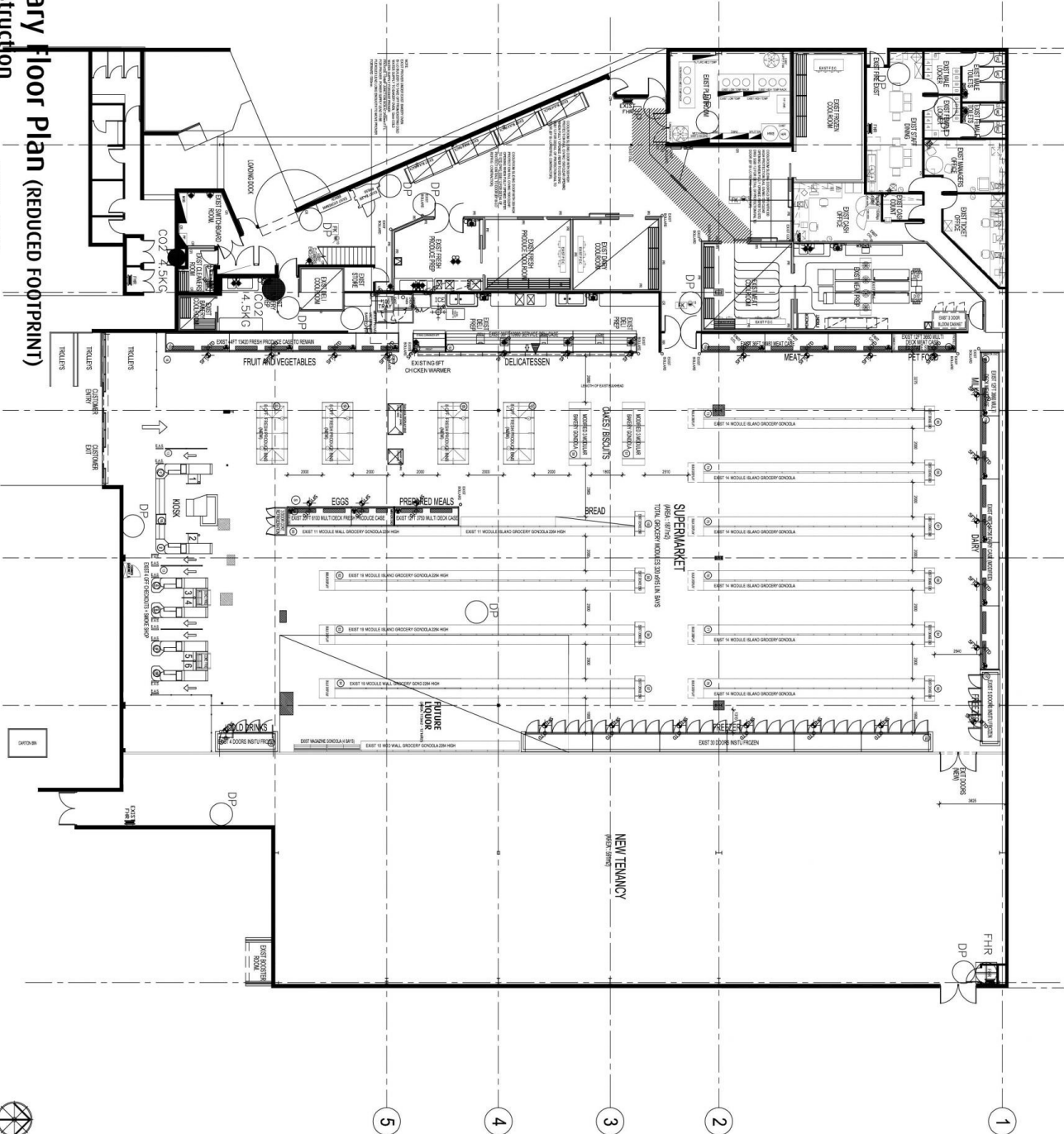

**Preliminary Floor Plan (REDUCED FOOTPRINT)**  
 not for construction

FLOOR PLAN SCALE 1:100



**RETAIL design**  
**FOODWORKS**

277 N. 4th Street, Suite 100  
 Minneapolis, MN 55401  
 P: (612) 338-5500  
 F: (612) 338-5500  
 WWW.FOODWORKS.COM

**CLIENT**  
 Naginder Singh

**LOCATION**  
 FOODWORKS  
 REMAINDANCE DR. AND BROWN ST.  
 MINNEAPOLIS, MN

**PROJECT TYPE**  
 RETROFIT STORE

|             |            |
|-------------|------------|
| <b>DATE</b> | <b>NO.</b> |
| 08/20/2014  | 1-100      |
| <b>DATE</b> | <b>NO.</b> |
| 08/20/2014  | 1-100      |
| <b>DATE</b> | <b>NO.</b> |
| 08/20/2014  | 1-100      |
| <b>DATE</b> | <b>NO.</b> |
| 08/20/2014  | 1-100      |