

2/6-8 Ralph Black Drive North Wollongong NSW

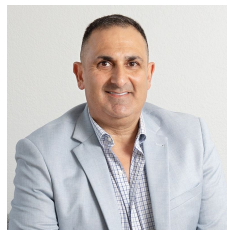

- Positioned in North Wollongong Industrial Park
- Rare to find vacant units
- Approx 100 sqm Industrial unit
- Includes 1 off street parking space
- Would suit multiple businesses
- Available from 10th October 2019

Type : Industrial
Land Size : 115 sqm
View : <https://www.whkcommercial.com.au/lease/nsw/wollongong-illawarra/north-wollongong/commercial/industrial/8069748>



Harry Stefanou
02 4229 6640

M.M

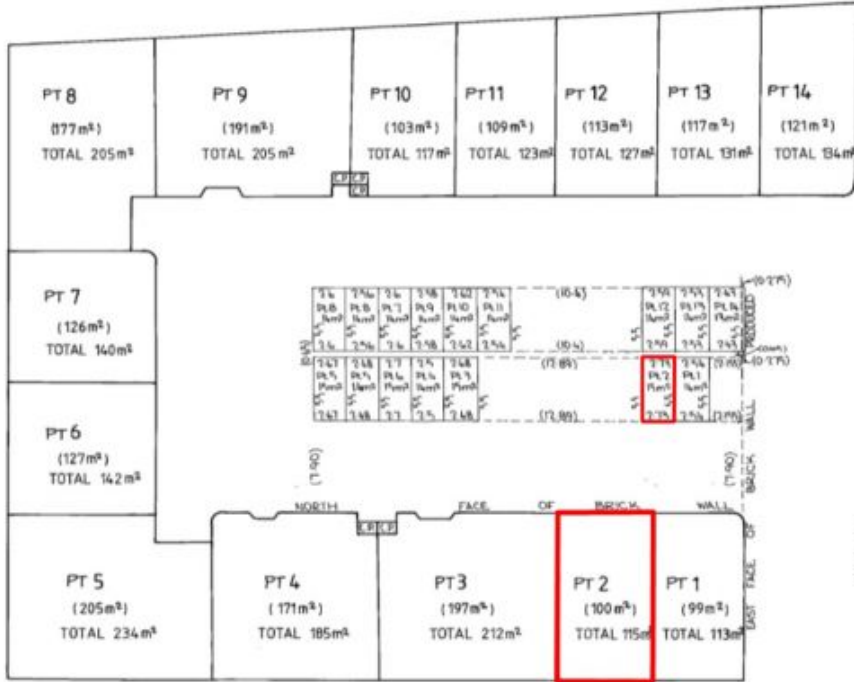

UNIT	ENTITLEMENT
1	101
2	102
3	201
4	104
5	105
6	106
7	107
8	108
9	109
10	110
11	111
12	112
13	113
14	114
TOTAL	2000

C.P. DENOTES COMMON PROPERTY
 THE HEIGHT OF THE CAR SPACES IS RESTRICTED TO 3 ABOVE THE UPPER SURFACE OF THEIR CONCRETE FLOOR.

Reduction Ratio 1:250

Lengths are in metres

D. A. G. G. G.
 Registered Surveyor

R. J. J. J.
 Attorney

SURVEYOR'S REFERENCE: 92750

