



**5/250 Nolan Street Unanderra NSW**

10 

- \* 1258sqm Warehouse with 5 high clearance roller door access
- \* 368sqm modern office space split over two levels
- \* Removable Inbuilt shop front
- \* 520 sqm basement storage area
- \* 10 plus parking and great large vehicle access with dual entry/exits
- \* Prominent location in Unanderra Industrial centre
- \* Great signage rights and exposure
- \* Concreted floor and with private access

**Type** : Industrial  
**Building Size** : 2146 sqm  
**Land Size** : 5240 sqm  
**View** : <https://www.whkcommercial.com.au/lease/nsw/wollongong-illawarra/unanderra/commercial/industrial/8069788>



**Harry Stefanou**  
02 4229 6640



**Mark Marinelli**  
02 4229 6640

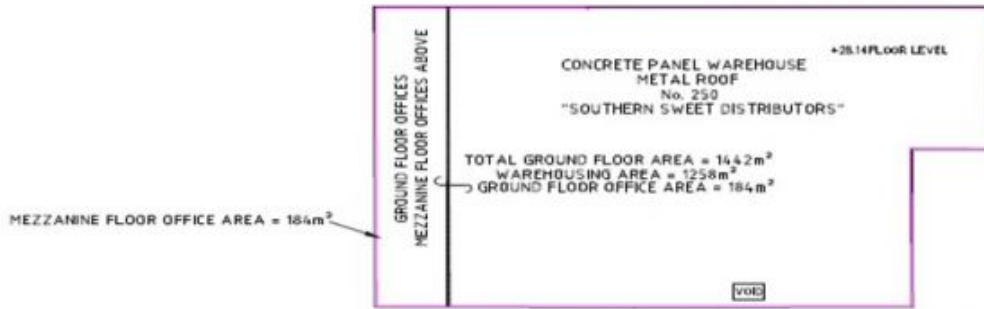

GROUND FLOOR PLAN



BASEMENT FLOOR PLAN