



### 398 Keira Street Wollongong NSW

13 

- \* 1053m2 ground floor showroom and amenities
- \* 220m2 approx mezzanine area
- \* 13 off street car spaces Plus ample street parking in area
- \* DA approved for Gym
- \* Ducted Air conditioning throughout showroom area
- \* High exposure site on main thoroughfare to Wollongong CBD

**Type** : Showrooms/Bulky Goods  
**Building Size** : 1273 sqm  
**Land Size** : 1958 sqm  
**View** : <https://www.whkcommercial.com.au/lease/nsw/wollongong-illawarra/wollongong/commercial/showroomsbulky-goods/8069931>



**Tony Moschella**

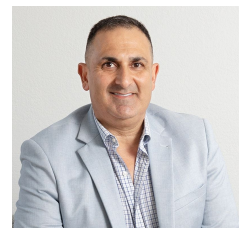

**Harry Stefanou**

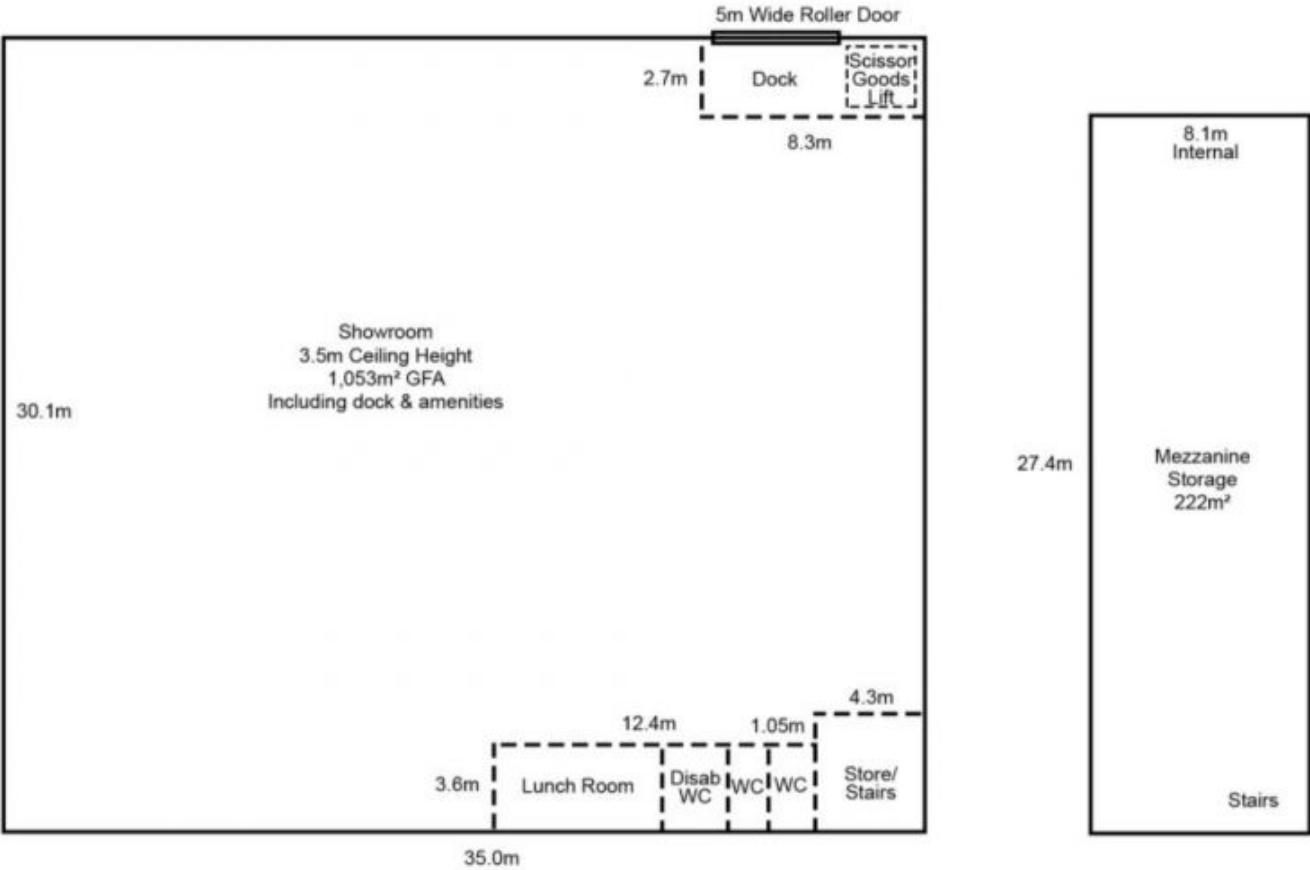

11 Car Parking Spaces Including 1 Disabled Space

\* All sizes and dimensions are approximate only