



**4/219 Princes Highway Unanderra NSW**

**2** 

\* 97 sqm of warehouse - 3 Phase Power / High Clearance / Electric Roller Doors

\* Fully enclosed 30 sqm office/mezz - gyprock walls, flooring, NBN and lighting

\* 2 off - street car spaces with great signage rights available

\* IN2 - Light Industrial - suitable for many businesses

\* Ready to Occupy 1st of June 2022

**Type** : Industrial  
**Building Size** : 127 sqm  
**Land Size** : 978 sqm  
**View** : <https://www.whkcommercial.com.au/lease/nsw/wollongong-illawarra/unanderra/commercial/industrial/8069954>



**Mark Marinelli**  
02 4229 6640



**Tony Moschella**  
02 4229 6640



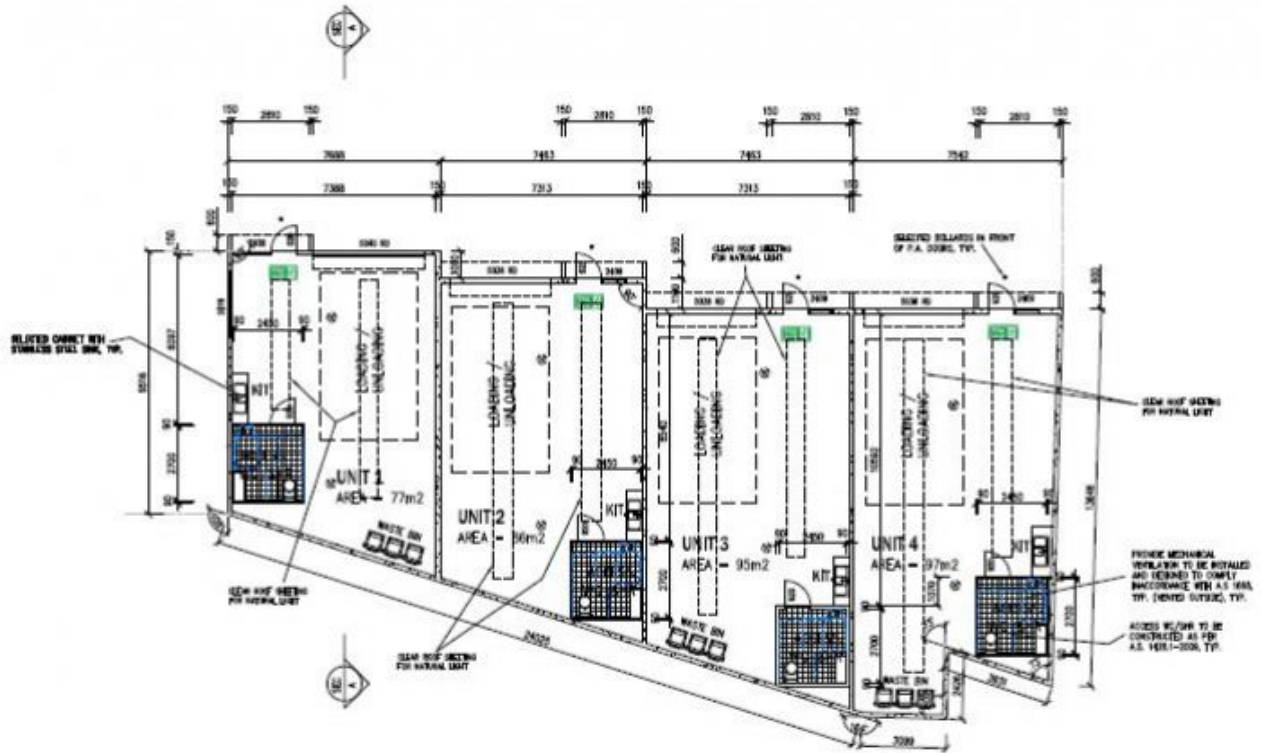

## FLOOR PLAN

SCALE 1:100 @ A1