



6 Doyle Avenue Unanderra NSW

10 

- * Newly Renovated Warehouse with Offices - 1085m²
- * Includes NEW 5 tonne gantry crane
- * 3 x Extra Wide & High sliding doors - approx 5.7m x 6m
- * New Air conditioning, kitchen and office fit out
- * Wide Yard Space with good Heavy vehicle access.
- * Well Established Industrial Precinct

Type : Industrial
Building Size : 1085 sqm
Land Size : 2159 sqm
View : <https://www.whkcommercial.com.au/lease/nsw/wollongong-illawarra/unanderra/commercial/industrial/8069998>



Tony Moschella
02 4229 6640

PROPERTY - 6 DOYLE AVENUE, UNANDERRA

DRAWING REPLICATED FROM ORIGINAL
 D.A. SUBMISSION DRAWING - ALL WORKSHOP
 MEASUREMENTS AND BUILDING TO BOUNDARY
 LOCATIONS ARE AS PER ORIGINAL.

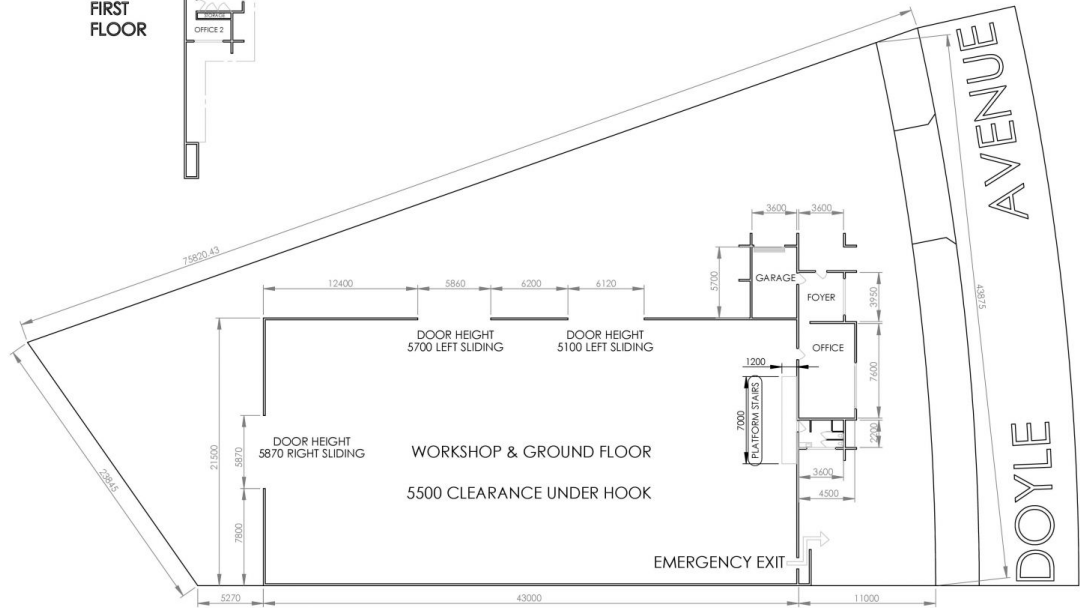

INTERNAL AREA AVERAGES	
WORKSHOP SPACE	925 m ²
TOTAL OFFICE SPACE GROUND & 1ST FLOORS	140 m ²
GARAGE AREA - GROUND FLOOR	20.5 m ²