



4/12 Marshall Street Dapto NSW

2 

- * Brand new modern unit
- * Excellent location in Dapto
- * Total size is 181 sqm
- * Includes 3 phase power
- * Completion July/August 2024

Type : Industrial
Price : \$36,200+GST+Outgoings pa
View : <https://www.whkcommercial.com.au/lease/nsw/wollongong-illawarra/dapto/commercial/industrial/8070096>



Tony Moschella
02 4229 6640

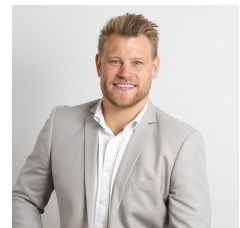

Shaun Baulch
02 4229 6640

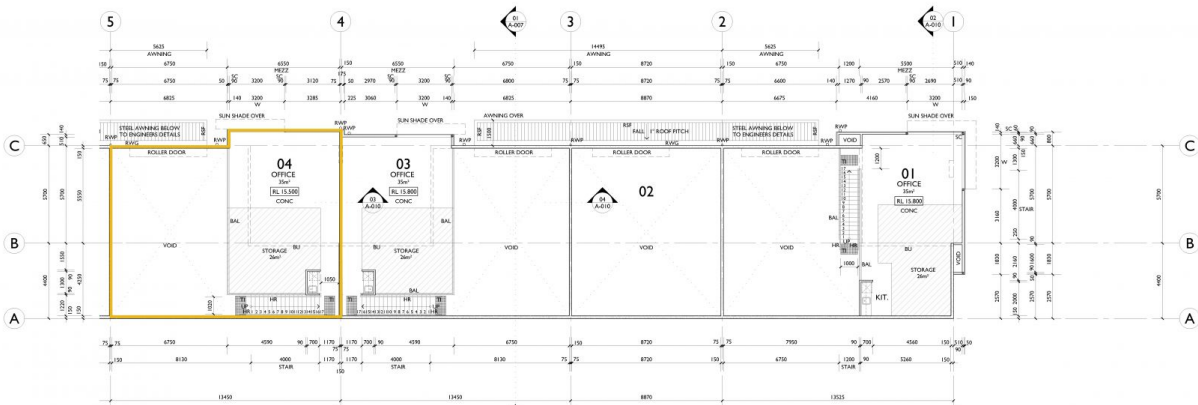
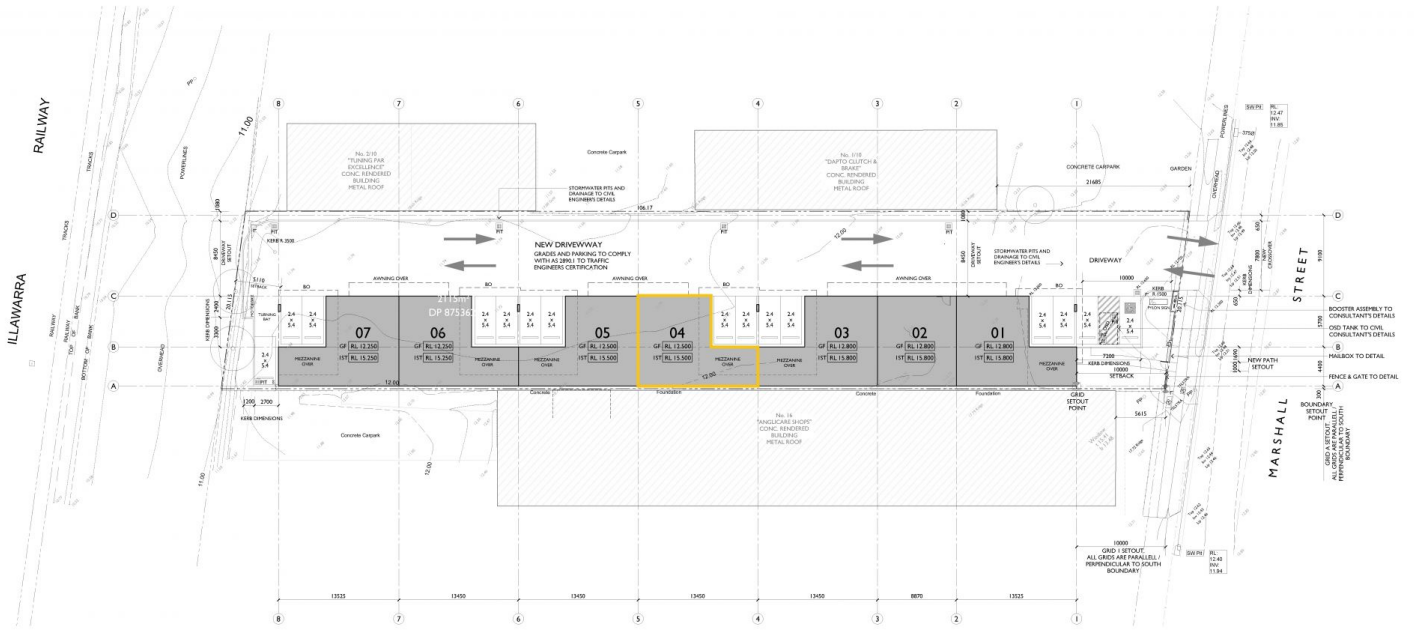

01 MEZZANINE FLOOR PLAN. UNITS 1 - 4
SCALE 1:100 @ A1

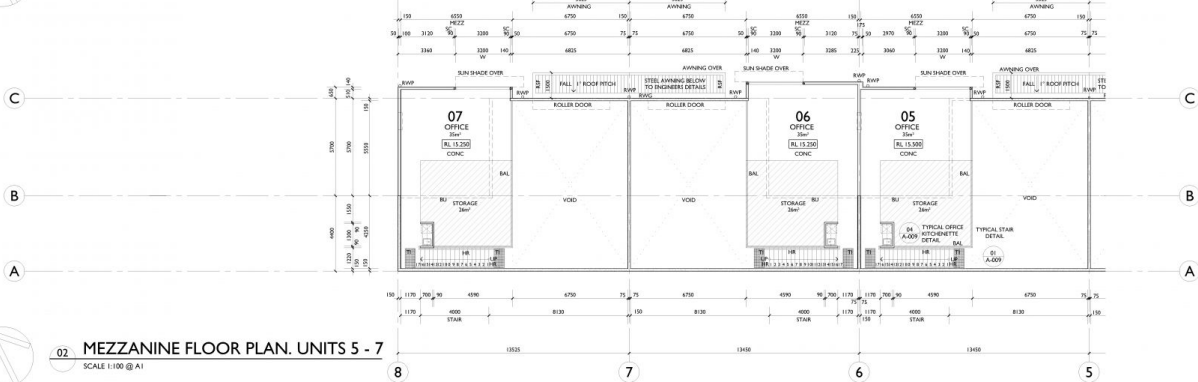

02 MEZZANINE FLOOR PLAN. UNITS 5 - 7
SCALE 1:100 @ A1