



7/21 Doyle Avenue Unanderra NSW

3 

- * Warehouse 184m² - Mezzanine 69m² (Total 253m²)
- * Modern Tilt - Up Concrete Design
- * High Clearance roller doors with higher internal clearance
- * Secure fence and electric gated complex
- * Multiple car spaces per unit with ample visitor parking
- * Good vehicle access
- * Close proximity to major arterial roads
- * Located in the industrial and commercial hub of Unanderra
- * 90 mins to Sydney / 10 Mins to Wollongong / 5 mins to Port Kembla

** Units 5 - 18 are also available For Sale **

Type	: Industrial
Price	: \$59,500 + GST + Outgoings pa
Building Size	: 253 sqm
View	: https://www.whkcommercial.com.au/lease/nsw/wollongong-illawarra/unanderra/commercial/industrial/8070118

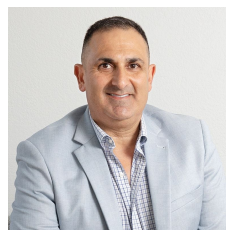

Harry Stefanou
02 4229 6640



Elena Koroleva
02 4229 6640

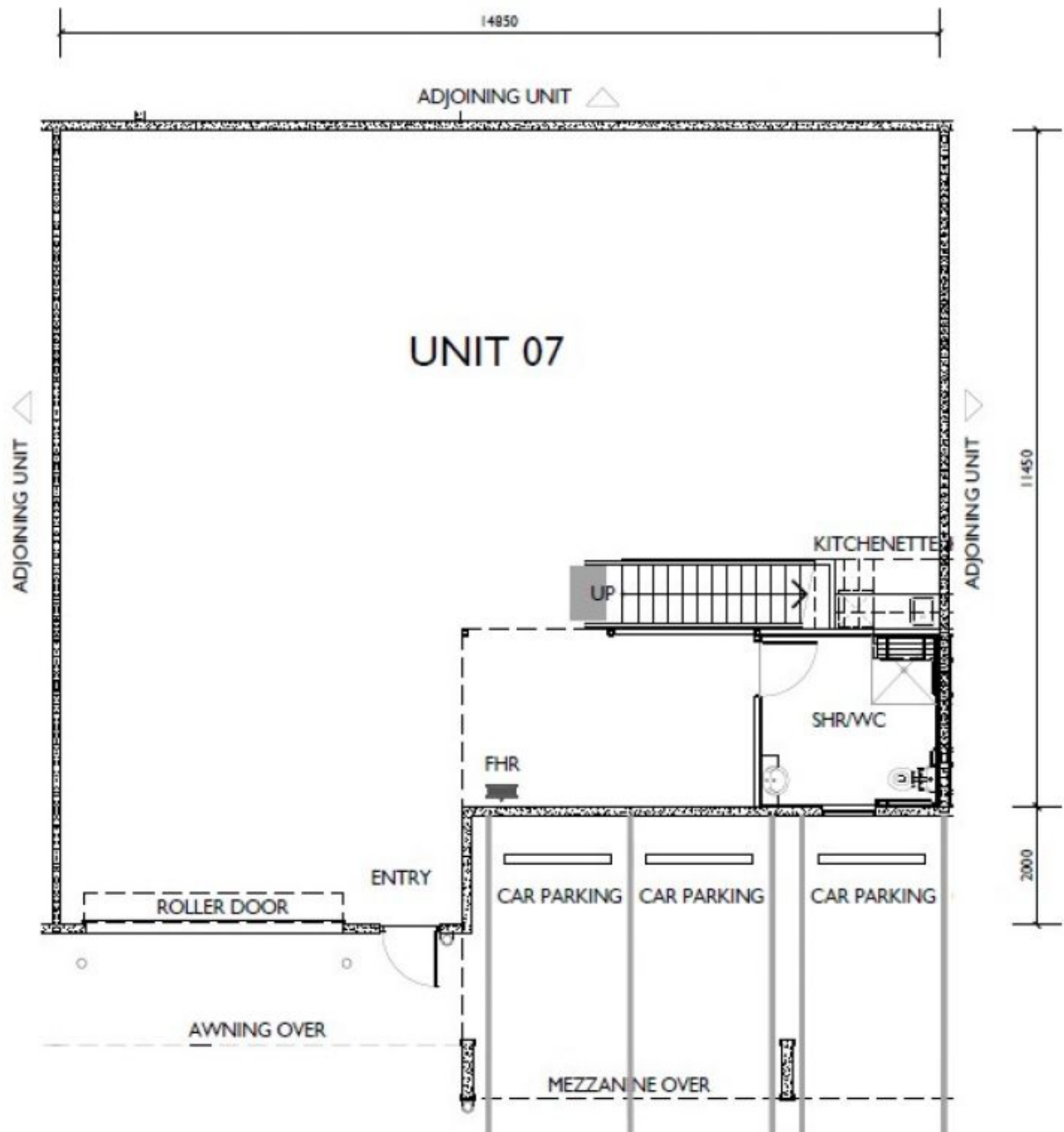

UNIT 07 - GROUND FLOOR PLAN
19 - 23 DOYLE AVENUE, UNANDERRA
LIGHT INDUSTRIAL UNITS



note - these drawings are to be used for marketing purposes only. Layout may change at owners discretion. © copyright admarchitects 2023
- areas subject to strata plan

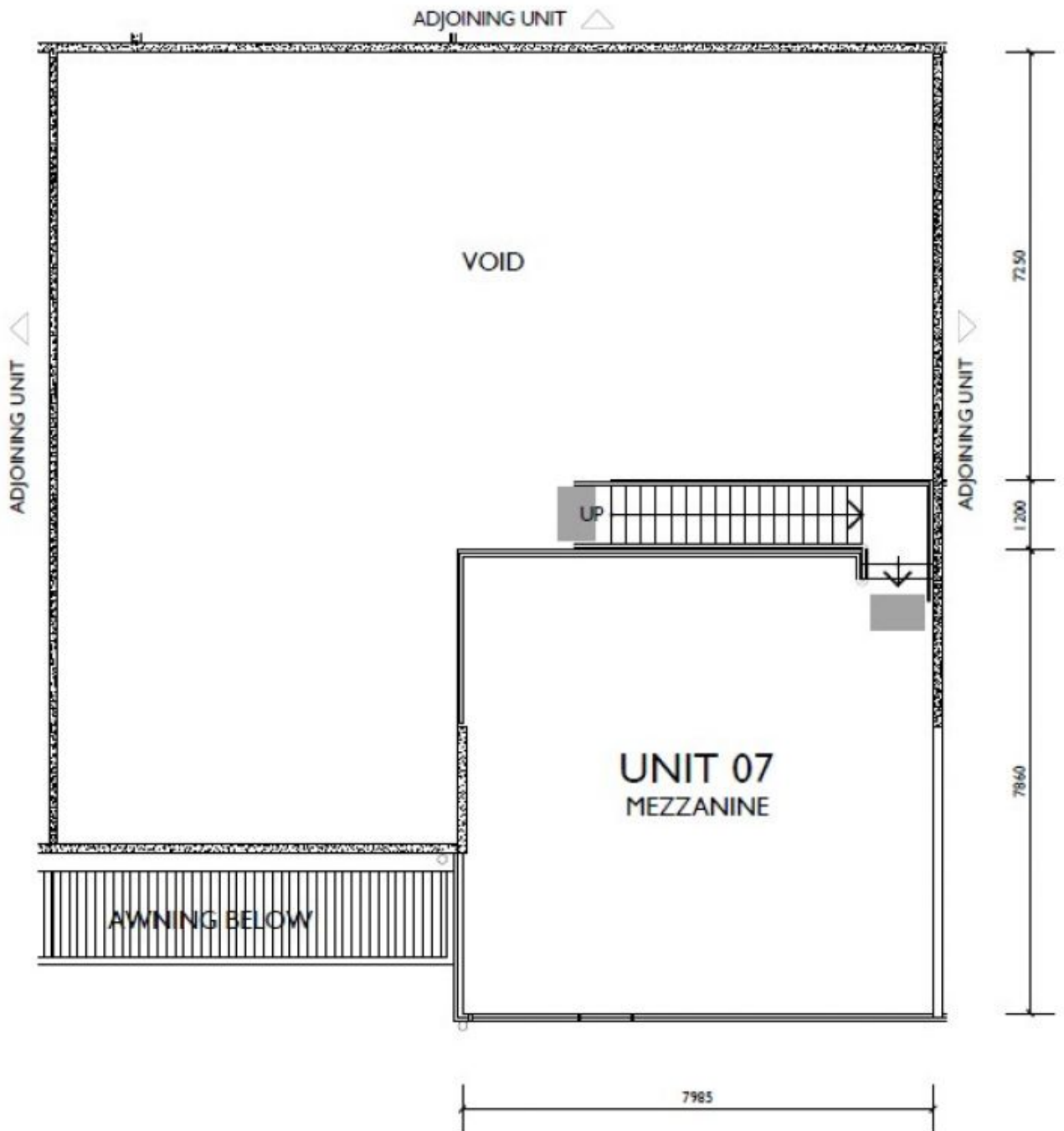

UNIT 07 - MEZZANINE PLAN
19 - 23 DOYLE AVENUE, UNANDERRA
LIGHT INDUSTRIAL UNITS



note - these drawings are to be used for marketing purposes only. Layout may change at owners discretion. © copyright admarchitects 2023
- areas subject to strata plan