



## 6/12 Marshall Street Dapto NSW

2 

- \* Modern Boutique complex - 181 sqm
- \* Close to Dapto CBD location
- \* Easy Access to major arterial roads
- \* Includes 3 phase power
- \* Includes 2 x Parking spaces
- \* Off-street parking
- \* Completion August 2024

**Type** : Industrial  
**Price** : Contact Agent pa  
**View** : <https://www.whkcommercial.com.au/lease/nsw/wollongong-illawarra/dapto/commercial/industrial/8070148>

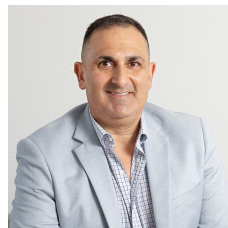

**Harry Stefanou**  
02 4229 6640



**Tony Moschella**  
02 4229 6640



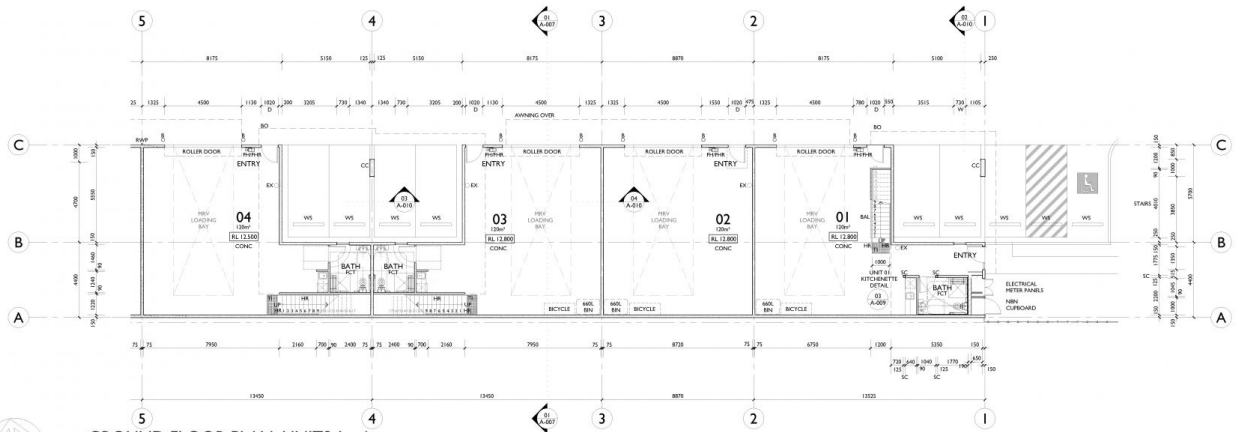

01 GROUND FLOOR PLAN. UNITS 1 - 4  
SCALE 1:100 @ A1

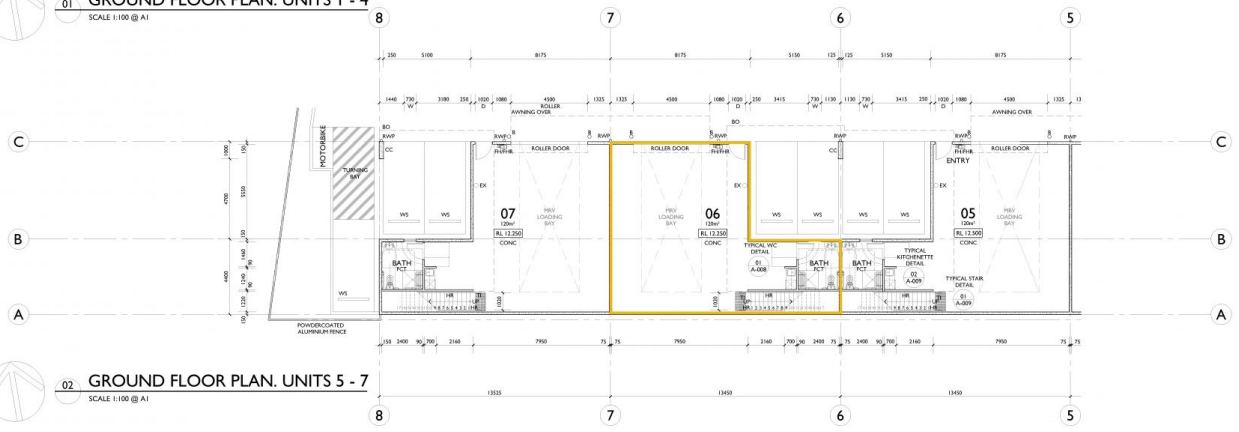

02 GROUND FLOOR PLAN. UNITS 5 - 7  
SCALE 1:100 @ A1